

F. Population Census Summary

CITY OF EDNA BAY

Census Enumerator or Contact:

Name: Myla Poelstra, City Clerk

Phone: (907) 594-6300

Date(s) population census was conducted:

March 14, 2022

I have attached the following required documentation:

- Map of municipality, community or reserve legal limits
- Census Schedule of housing units/individual names
- Population Resolution

Population Census Results:

Total Resident Population:	<u>55</u>
Residents in Housing Units:	<u>55</u>
Residents in Group Quarters:	<u>0</u>
Total Housing Units:	<u>44</u>
Occupied Housing Units:	<u>33</u>
Vacant Housing Units:	<u>11</u>

A.S.L.S. No. 81-116
 EDNA BAY SUBDIVISION LADS No. 0293-82-3-2
 SUBDIVISION OF A PORTION OF THE NE 1/4 NW 1/4 SEC
 28, LOTS 1 AND 2 SEC 28, LOT 1 SEC 27, SE 1/4 SW 1/4
 SEC 21, S 1/2 SE 1/4 SEC 21, LOTS 2, 6 & 7 SEC 22, W 1/2
 NW 1/4 SEC 22, NE 1/4 NW 1/4 SEC 22, W 1/2 SEC 23
 AND LOTS 2 & 3 SEC 26 T68S, R76E, COPPER RIVER
 MERIDIAN, ALASKA



USFS TONGASS NATIONAL FOREST

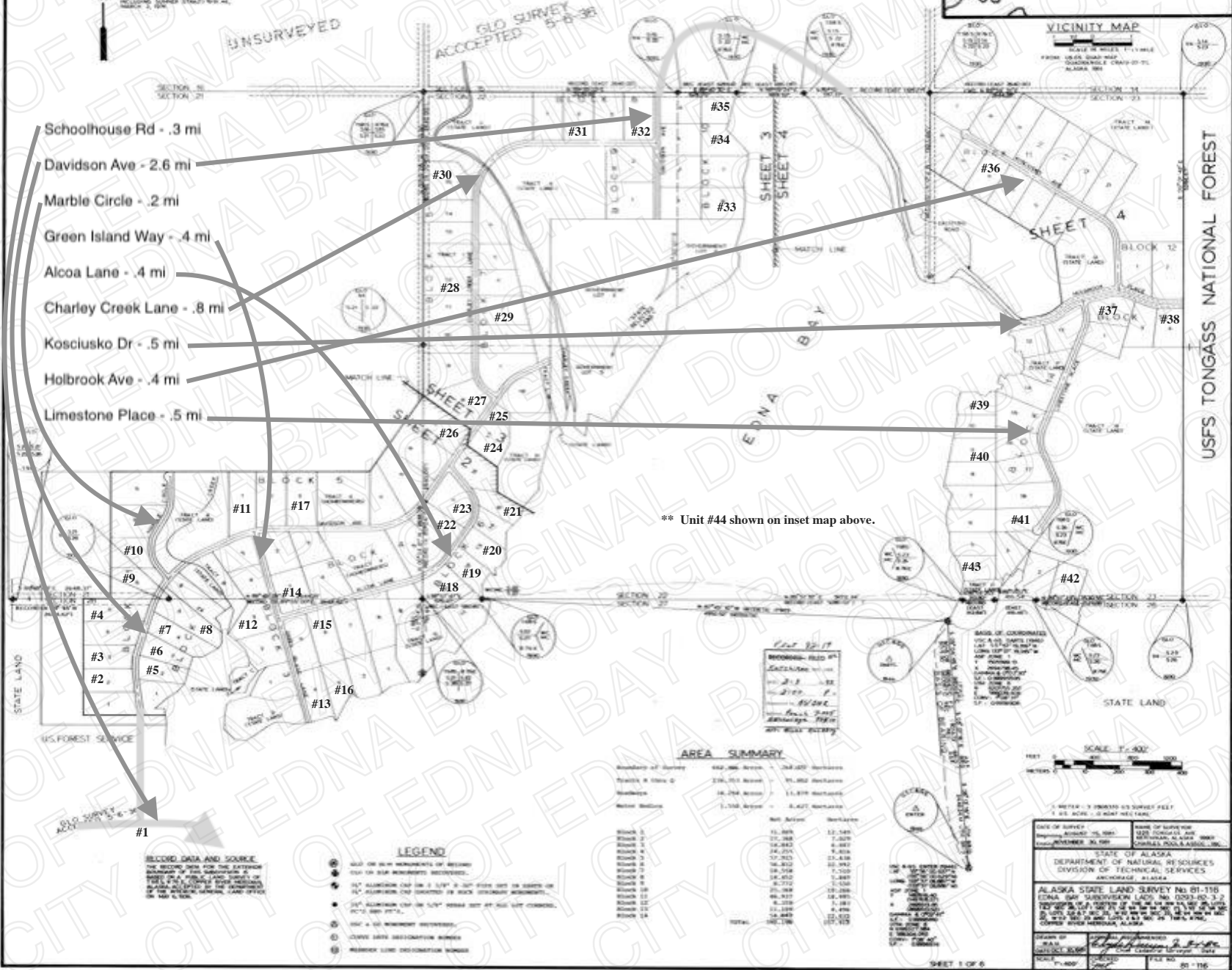

** Unit #44 shown on inset map above.

RECORD DATA AND SOURCE
 THE RECORD DATA FOR THE EXTENSION
 OF THIS PUBLIC LAND SURVEY OF
 THE ALASKA PUBLIC LAND SURVEY
 SYSTEM, AS APPLIED TO THE EXTENSION
 OF THIS PUBLIC LAND SURVEY, WAS OBTAINED
 FROM THE RECORDS OF THE ALASKA
 DEPARTMENT OF NATURAL RESOURCES,
 ANCHORAGE, ALASKA.

- LEGEND**
- 1. BOUNDARY OF SURVEY
 - 2. STATE LAND
 - 3. US FOREST SERVICE
 - 4. UNDEVELOPED LAND
 - 5. DEVELOPED LAND
 - 6. ROAD
 - 7. RAILROAD
 - 8. WATER
 - 9. WETLAND
 - 10. CULTIVATED LAND
 - 11. MINERAL
 - 12. OTHER

AREA SUMMARY

Boundary of Survey	Sq. Mile Area	Total Sq. Feet
Block 1	11.868	32,549
Block 2	11.868	32,549
Block 3	11.868	32,549
Block 4	11.868	32,549
Block 5	11.868	32,549
Block 6	11.868	32,549
Block 7	11.868	32,549
Block 8	11.868	32,549
Block 9	11.868	32,549
Block 10	11.868	32,549
Block 11	11.868	32,549
Block 12	11.868	32,549
Block 13	11.868	32,549
Block 14	11.868	32,549
Total	162.168	477,112

STATE OF ALASKA
 DEPARTMENT OF NATURAL RESOURCES
 DIVISION OF TECHNICAL SERVICES
 ANCHORAGE, ALASKA

ALASKA STATE LAND SURVEY No. 81-116
 EDNA BAY SUBDIVISION LADS No. 0293-82-3-2
 TONGASS NATIONAL FOREST OF THE USFS, NE 1/4 NW 1/4 SEC 28, LOT 1 SEC 27, SE 1/4 SW 1/4 SEC 21, S 1/2 SE 1/4 SEC 21, LOTS 2, 6 & 7 SEC 22, W 1/2 NW 1/4 SEC 22, NE 1/4 NW 1/4 SEC 22, W 1/2 SEC 23 AND LOTS 2 & 3 SEC 26 T68S, R76E, COPPER RIVER MERIDIAN, ALASKA

DATE OF SURVEY: November 20, 1991
 NAME OF SURVEYOR: [Signature]
 TITLE: [Title]

SCALE: 1" = 400'

FILE NO. 82-19

III. Attachments

A. Census - Housing Units, Occupancy Status and Residents

CITY OF EDNA BAY

(Name of the municipality, community or reserve)

Enumerator: _____

Date: March 14, 2022

Block: _____

Page: 1

Hsng. Unit #	Housing Unit Address	Housing Unit		Names of Individuals in Household	Do you consider this house your primary place of residence*	
		Occupied	Vacant		Yes	No
#1	#1 Schoolhouse Ln		X	Teacher housing (SISD)		X
#2	Block 1 Lot 2	X		Poelstra, Brian	X	
#2				Poelstra, Jacque	X	
#2				Poelstra, Ariadne	X	
#2				Poelstra, Orian	X	
#2				Poelstra, Reamae	X	
#3	Block 1 Lot 3	X		Poelstra, Terry	X	
#3				Poelstra, Myla	X	
#3				Poelstra, Tyler	X	
#3				Poelstra, Teran	X	
#3				Buss, Katie	X	
#3				Nelson, Summer	X	
#4	Block 1 Lot 5	X		Hendershot, Tony	X	
#4				Reinard, Lee	X	
#5	Block 2 Lot 2		X	Dodson, Jeanette		X
#6	Block 2 Lot 3	X		Wargi, Sharon	X	
#6				Wargi, Joseph	X	
#7	Block 2 Lot 4	FOR SALE	X	Bartels, Russ		X
#8	Block 2 Lot 5	X		Crew, Jere	X	
#8				Crew, Susan	X	
#8				Crew, Rebecca	X	
Housing Subtotal		5	3		18	3

*"Primary place of residence" means a place where a person sleeps on a weekly basis; if a person has more than one residence, "primary place of residence" means a place where the person sleeps more often during the calendar year.

III. Attachments

A. Census - Housing Units, Occupancy Status and Residents

CITY OF EDNA BAY

(Name of the municipality, community or reserve)

Enumerator: _____

Date: March 14, 2022

Block: _____

Page: 2

Hsng. Unit #	Housing Unit Address	Housing Unit		Names of Individuals in Household	Do you consider this house your primary place of residence*	
		Occupied	Vacant		Yes	No
#9	Block 1 Lot 7		X	Crew, Robin		X
#10	Block 1 Lot 8	X		Haag, Paul	X	
#11	Block 5 Lot 1		X	Besse, John		X
#12	Block 3 Lot 3	X		Towne, Jay		X
#13	Block 6 Lot 5	X		Larson, John		X
#14	Block 4 Lot 1	FOR SALE	X	Richter, Pat		X
#15	Block 6 Lot 6	X		Stockdale, Richard	X	
#15				Viera, Maureen	X	
#16	Block 6 Lot 3	X		Widmyer, Jimmy	X	
#17	Block 5 Lot 3	X		Fish, Robert	X	
#18	Block 6 Lot 10	X		Weber, David		X
#19	Block 6 Lot 12	X		Bartels, Russ	X	
#19				Bartels, Charleen	X	
#20	Block 6 Lot 13	X		Widmyer, Kenny	X	
#21	Block 6 Lot 15	X		Donninger, Jeff		X
#22	Block 6 Lot 6	X		Galloway, Pat	X	
#23	Block 6 Lot 7	X		Kitson, Caleb	X	
#23				Kitson, Shayla	X	
#23				Kitson, Axel	X	
#23				Kitson, Lyric	X	
#23				Kitson, Boaz	X	
Housing Subtotal		12	3		14	7

*"Primary place of residence" means a place where a person sleeps on a weekly basis; if a person has more than one residence, "primary place of residence" means a place where the person sleeps more often during the calendar year.

III. Attachments

A. Census - Housing Units, Occupancy Status and Residents

CITY OF EDNA BAY

(Name of the municipality, community or reserve)

Enumerator: _____

Date: March 14, 2022

Block: _____

Page: 3

Hsng. Unit #	Housing Unit Address	Housing Unit		Names of Individuals in Household	Do you consider this house your primary place of residence*	
		Occupied	Vacant		Yes	No
#23				Kitson, Adelaide	X	
#23				Kitson, Axchsa	X	
#24	Block 6 Lot 17	X		Rhodes, Fran	X	
#24				Rhodes, Kody	X	
#25	Block 6 Lot 18	X		Dodson, John	X	
#26	Block 5 Lot 7	X		Boos, Harry		X
#27	Block 5 Lot 8	X		Rotola, Christian	X	
#28	Block 5 Lot 12	X		Greif, Doris	X	
#29	Block 7 Lot 3		X	Woodhouse, Mike		X
#30	Block 5 Lot 15	X		Henson, Scott	X	
#30				Henson, Sandy	X	
#31	Block 8 Lot 2		X	Schultz, Adam		X
#32	Block 8 Lot 4	X		Schallberger, Steve	X	
#33	Block 10 Lot 8	X		Cattani, Bruce	X	
#33				Cattani, Camille	X	
#33				Richter, Sophia	X	
#33				Cattani, Piper	X	
#33				Cattani, Vince	X	
#34	Block 10 Lot 6	X		Mortensen, Brian	X	
#34				Tennant, Becky	X	
#35	Block 10 Lot 5		X	Lamkin, Spencer		X
	Housing Subtotal	9	3		17	4

*"Primary place of residence" means a place where a person sleeps on a weekly basis; if a person has more than one residence, "primary place of residence" means a place where the person sleeps more often during the calendar year.

III. Attachments

A. Census - Housing Units, Occupancy Status and Residents

CITY OF EDNA BAY (Name of the municipality, community or reserve)

Enumerator: _____

Date: March 14, 2022

Block: _____

Page: 4

Hsng. Unit #	Housing Unit Address	Housing Unit		Names of Individuals in Household	Do you consider this house your primary place of residence*	
		Occupied	Vacant		Yes	No
#36	Block 11 Lot 4		X	Brown, Mike		X
#37	Block 13 Lot 2	X		DiPaolo, Roger	X	
#37				DiPaolo, Louise	X	
#38	Block 13 Lot 4	X		Sauer, Jonathan		X
#39	Block 14 Lot 11	X		Thompson, Brad	X	
#40	Block 14 Lot 9	X		Williams, Mike	X	
#40				Williams, Karen	X	
#41	Block 14 Lot 18	X		Richter, Logan	X	
#42	Block 14 Lot 1	X		Gruenberg, Steve		X
#43	Block 14 Lot 4	FOR SALE	X	Pat Richter		X
#44	US Mining Patent	X		Pat Richter		X
	Housing Subtotal	7	2		6	5

*“Primary place of residence” means a place where a person sleeps on a weekly basis; if a person has more than one residence, “primary place of residence” means a place where the person sleeps more often during the calendar year.

G. Population Resolution #2022-32

A RESOLUTION OF THE CITY OF EDNA BAY adopting the
(Municipality, community or reserve)
determination of population.

WHEREAS, the CITY OF EDNA BAY has conducted a census of the
(Municipality, community or reserve)
population indicating the population of permanent residents as of
March 14, 2022; and
(Date)

WHEREAS, the governing body of the CITY OF EDNA BAY must pass a
(Municipality, community or reserve)
Resolution adopting the results of the census for use by the Department of Commerce,
Community and Economic Development;

NOW THEREFORE BE IT RESOLVED THAT the governing body finds that on
March 14, 2022 the population of permanent residents of the
(Date)
CITY OF EDNA BAY was 55.
(Municipality, community or reserve) (Population)

PASSED AND APPROVED BY THE CITY OF EDNA BAY on the
(Municipality, community or reserve)
14th Day of March, 2022.
(Day) (Month) (Year)

BY: _____
Tyler M Poelstra, Mayor

ATTEST: _____
Myla R Poelstra, Clerk